

AARON MANUFACTURING INC.

UPPER SHELVING OVER WORK TABLES MODELS # AOS5 & AOS6

DATE: 8-17-04

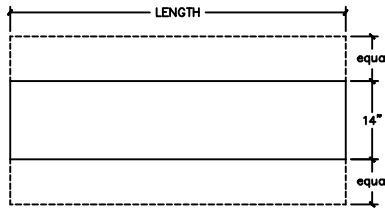

PLAN VIEW

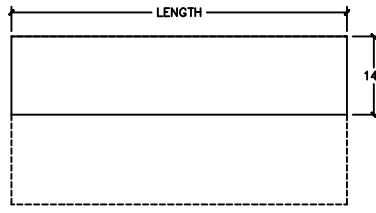

PLAN VIEW

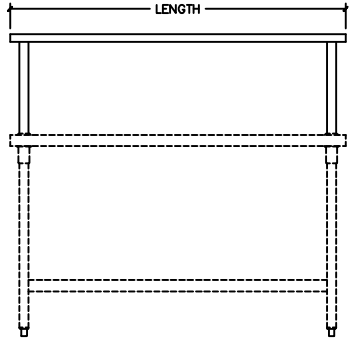

ELEVATION VIEW

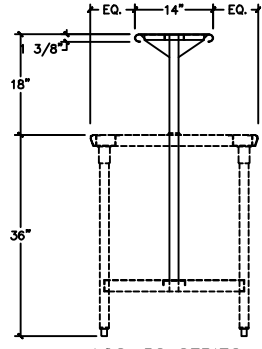

AOS-5S SERIES

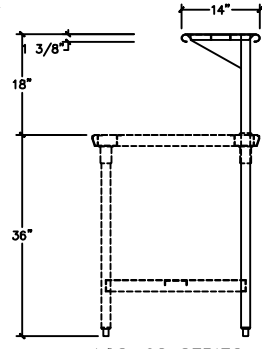

AOS-6S SERIES

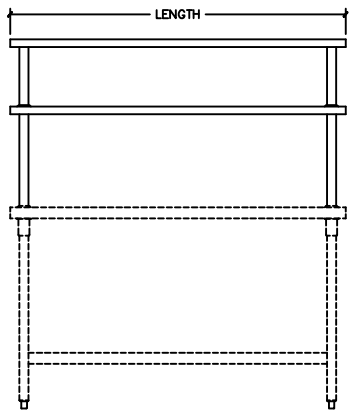

ELEVATION VIEW

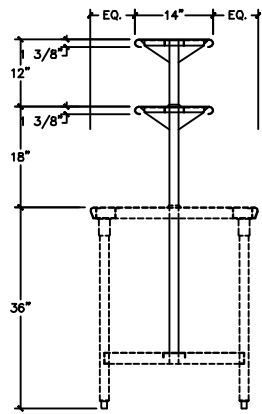

AOS-5D SERIES

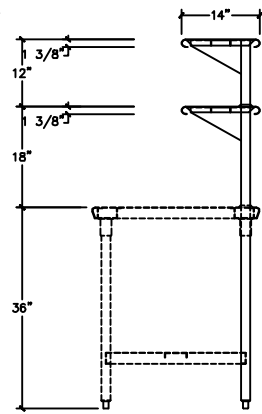

AOS-6D SERIES

MODEL # AOS SERIES UPPER SHELF SPECIFICATIONS										
depth x length in.	length mm	# of tube supports	model # fixed	model # fixed	weight lbs.	weight kg.	model # fixed	model # fixed	weight lbs.	weight kg.
14" x 24"	356 x 610	2	AOS-5S-24	AOS-6S-24	20	9.1	AOS-5D-24	AOS-6D-24	35	15.9
14" x 30"	356 x 762	2	AOS-5S-30	AOS-6S-30	25	11.3	AOS-5D-30	AOS-6D-30	45	20.4
14" x 36"	356 x 914	2	AOS-5S-36	AOS-6S-36	30	13.6	AOS-5D-36	AOS-6D-36	55	24.9
14" x 42"	356 x 1067	2	AOS-5S-42	AOS-6S-42	35	15.9	AOS-5D-42	AOS-6D-42	65	29.5
14" x 48"	356 x 1219	2	AOS-5S-48	AOS-6S-48	40	18.1	AOS-5D-48	AOS-6D-48	75	34.0
14" x 60"	356 x 1524	2	AOS-5S-60	AOS-6S-60	45	20.4	AOS-5D-60	AOS-6D-60	85	38.6
14" x 72"	356 x 1829	2	AOS-5S-72	AOS-6S-72	50	22.7	AOS-5D-72	AOS-6D-72	95	43.1
14" x 84"	356 x 2134	3	AOS-5S-84	AOS-6S-84	60	27.2	AOS-5D-84	AOS-6D-84	110	49.9
14" x 96"	356 x 2438	3	AOS-5S-96	AOS-6S-96	65	29.5	AOS-5D-96	AOS-6D-96	120	54.4
14" x 108"	356 x 2743	3	AOS-5S-108	AOS-6S-108	70	31.8	AOS-5D-108	AOS-6D-108	130	59.0
14" x 120"	356 x 3048	3	AOS-5S-120	AOS-6S-120	75	34.0	AOS-5D-120	AOS-6D-120	140	63.5

AARON MANUFACTURING INC.